

MAGNUM[®]

**Need Help?
1-888-443-8889**

MAGNUM 1/2 CU. YD. COVERED CAPACITY DUMP CARTS

ITEM NO.	DUMP CART DESCRIPTION
DUC12T	Without Frame

Assembly Instructions for Dump Carts with and without frames. Note applicable models in chart.

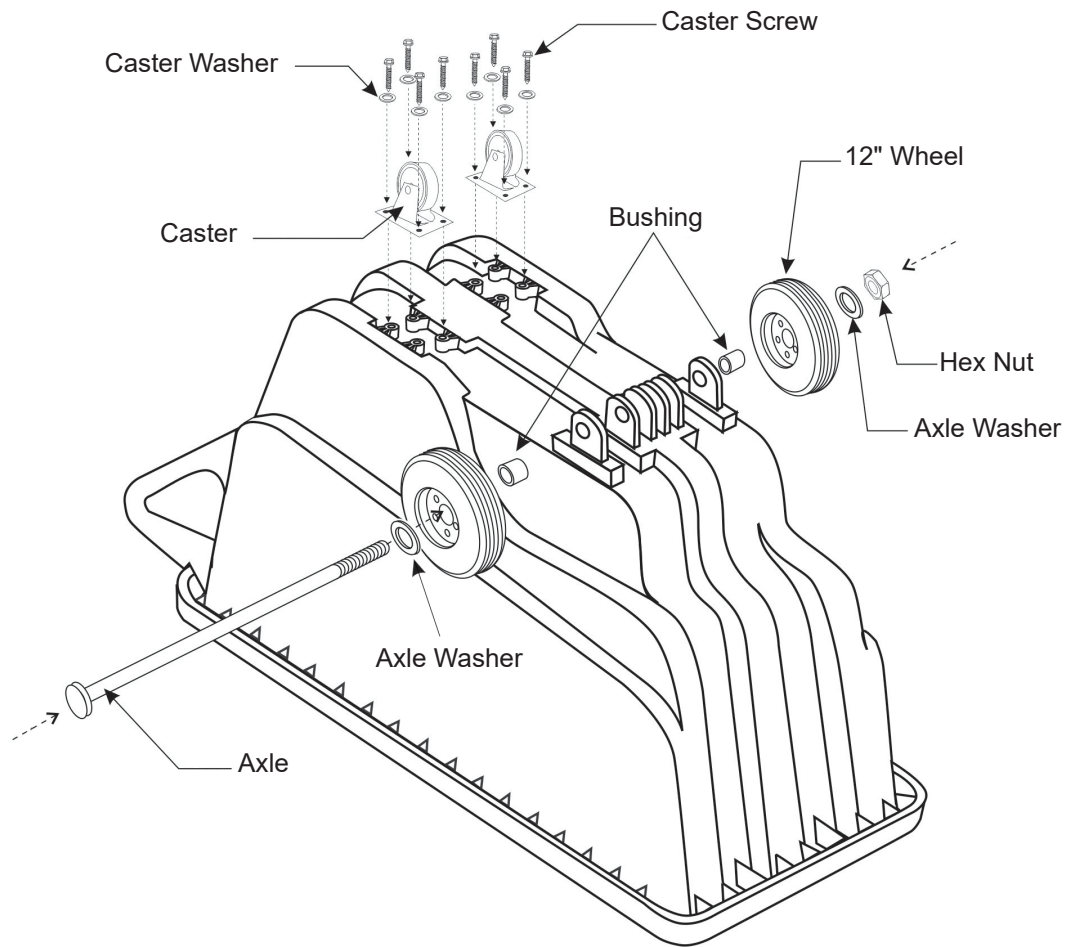

1 Install axle and attach wheels. Flat side of the wheel faces outward, while non-flat side faces the cart (shown in the illustration to the right). Secure hex nut, but do not overtighten. Overtightening will restrict wheel motion.

2 Attach casters to dump cart base using screws and washers (shown in the illustration above).

FACE OUTWARD

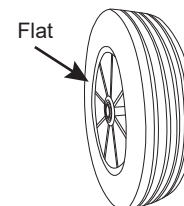

FACE CART

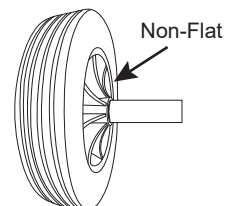



**Need Help?
1-888-443-8889**

**DUS12-T
DUMP CART ACCESSORY
KIT W/ HEAVY-DUTY
WHEELS & CASTERS**



FOR THE FOLLOWING DUMP CART MODELS

ITEM NO.	DUMP CART DESCRIPTION
DUC12T	Without Frame

ITEM NO.	ITEM DESCRIPTION	QUANTITY
CAS10	10" x 2 ³ / ₄ " Wheel	2
CAS4PS	4" x 2" Swivel Caster with Plate	2
DUA12-550	21-5/8" Axle	1
N/A	Axle Washer	2
N/A	Bushing	2
N/A	Caster Screw	8
N/A	Caster Washer	8
N/A	Hex Nut	1